

MADISON CENTRE

Property Information:

The Madison Office Tower is a six storey commercial office building located in the Lougheed corridor – one of BC’s fastest growing office markets. The Madison Tower provides bike storage and showers, abundant parking for both tenants and patrons, and a card access system to all entry points to ensure the security of its tenants.

The Madison Office Tower is comprised of 60,000 square feet leasable area on six floors, with both single and multi-tenant usage. The Madison Office Tower’s tenants include medical, consulting, insurance and accounting services.

Property Address:

4399 Lougheed Highway
Burnaby, BC V5C 3Y7

Location:

Intersection of Lougheed Highway and Madison Street (two blocks west of Willingdon) just north of Highway No 1.

Year Opened:

2000

Hours of Operation:

Madison Office Tower is open from 7am to 7pm,
Monday through Friday

Trade Area Population:

3 km radius 58,125

Trade Area Average Household Income:

\$55,000



Owned and developed by:
Appia Development Ltd.



Managed and leased by:
**Bosa Development
Property Management**

Courtney Beattie
500 - 1901 Rosser Avenue
Burnaby BC V5C 6S3
T: 604.294.0666 F: 604.291.9120
www.bosadev.com

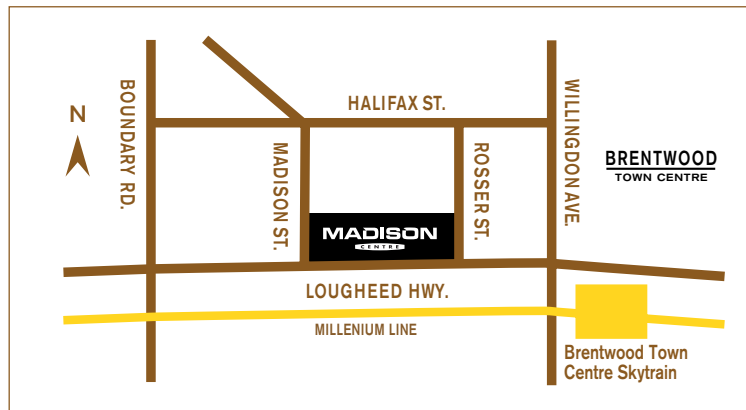
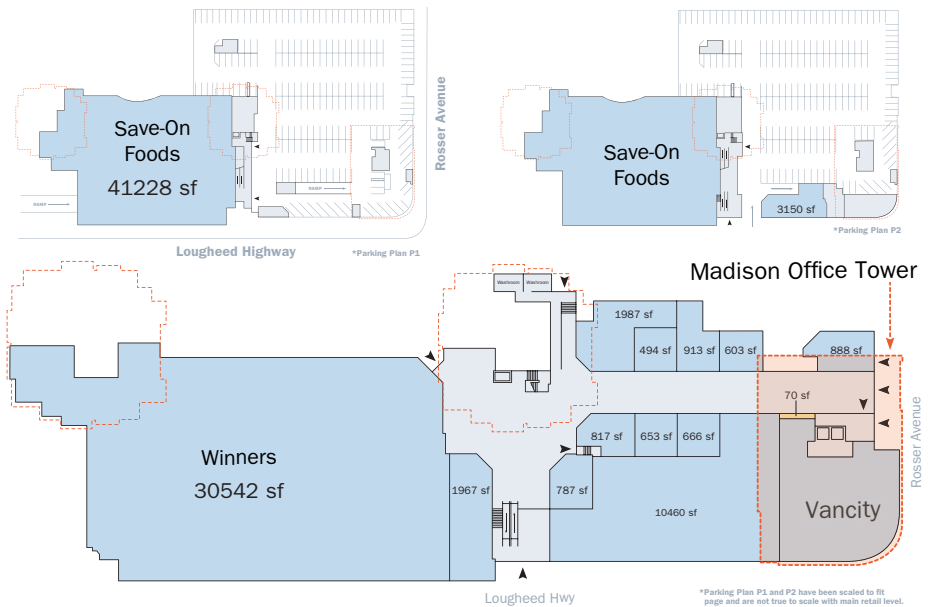

E & E Disclaimer: Information contained herein has been obtained from sources deemed reliable. We have no reason to doubt its accuracy, but regret we cannot guarantee it.

Tel: 604.294.0666 Fax: 604.291.9120

www.bosadev.com



Suite 101 - 8557 Government St.
Burnaby | BC | V3N 4S9
P 604 422 0174 | F 604 422 0175
www.goshervin.com

Client: Bosa Development
Docket Number: 4853
Project Name: Office Use - Inserts :: Madison
Program: [✓] InDesign, [] Illustrator, [] Other _____
Trim Size: 8.5"(w) x 11"(h)
Date Prepared: Feb 11, 2009
Proof Version: v07
Proof Output: 100%

Colour Space: [✓] CMYK, [] B&W, [] RGB, [] Spot(s) _____
Images: [] FPO, [✓] Final
Copy: [] FPO, [✓] Final
Printer/Supplier/Publication: _____
Designer: Michael
Creative Director: _____
Project Manager: _____